

# User manual

Standing frame

***Vision***<sup>®</sup>

Models:

Vision<sup>®</sup>, Vision<sup>®</sup> Jr.



Dear Customer!

We would like to thank you for your trust extended to us and for purchasing our product.

The standing frame Vision® 2000 distinguishes itself by its quality, security, easy operation and modern design.

For optimal use of this aid, we ask you and possible other users to carefully read this operating manual.



**Please read through these instructions carefully before first use and handle equipment appropriately!**

**2 Table of contents**

| Topic   | Page |
|---|------|
| 1 <b>Foreword</b> .....                       | 3    |
| 2 <b>Table of contents</b> .....              | 4    |
| 3 <b>Safety instructions</b> .....            | 5    |
| 4 <b>Warranty and product liability</b> ..... | 9    |
| 5 <b>CE sign and position</b> .....           | 9    |
| 6 <b>Indications and prophylaxis</b> .....    | 10   |
| 7 <b>Purpose of use</b> .....                 | 11   |
| 8 <b>Product overview</b> .....               | 12   |
| 8.1 Basic model .....                         | 12   |
| 8.2 Accessories / options .....               | 13   |
| 9 <b>Initial operation</b> .....              | 14   |
| 10 <b>Assembly and adjustment</b> .....       | 15   |
| 10.1 Basic model .....                        | 15   |
| 10.2 Accessories / options .....              | 22   |
| 11 <b>Types and accessories</b> .....         | 24   |
| 11.1 Basic model .....                        | 24   |
| 11.2 Accessories / options .....              | 25   |
| 12 <b>Technical details</b> .....             | 36   |
| 13 <b>Cleaning and disinfection</b> .....     | 27   |
| 14 <b>Maintenance and overhaul</b> .....      | 28   |
| 15 <b>Operating life and Re-use</b> .....     | 28   |
| 16 <b>Faults, repairs, spare parts</b> .....  | 28   |
| 17 <b>Storage</b> .....                       | 28   |

### 3 Safety instructions

The standing frame Vision® 2000 is CE-marked and fulfills the requirements of the latest directives. It was developed in line with most recent findings. Production is subject to an on-going quality control.

Please read this user manual carefully before operating the standing frame.

The user manual is an integral part of the Rehab aid. In case of loss, request a new copy or download directly from our download area on our homepage [www.ato-form.com](http://www.ato-form.com).

Please keep the user manual in a safe place, accessible to care and maintenance staff.

The user manual does not replace the experience of supervisory staff with the experience and knowledge of operators,

which they gained from (for example) training courses.



In the event of specific or difficult applications, the user manual represents a guide to the most important handling.

Ensure all users of this aid understand its handling and the meaning of the symbols attached to the device.

Accidents can be prevented when technical instructions according to the EWG guidelines are followed.

Protective coverings, labels and warning notices may not be removed.

The maximum load-bearing capacity of the Vision® 2000 is 150 kg.

 **Regular monitoring at your specialist dealer (at least once a year) lengthens the life time of the standing frame and gives you security.**  
 **Please also see section: maintenance and overhaul.**

### 3 Safety instructions

- Before mounting or using the standing frame Vision® 2000 carefully read all instructions of this user manual, as these have been drawn up for your safety and as a guideline for the correct use and maintenance of this product. This operating manual is an indispensable component of the delivery and should be stored carefully for further use.
- The operating manual is intended for retailers and users of the standing frame Vision® 2000, (or their carers). It contains the required information to secure the correct use of the product, it cannot, however replace the necessary experience of the user or assistant in handling the device.
- The reseller has the duty to deliver the device ready for operation and to explain precisely the functions and technical data of the device, as well as provide the necessary support and briefing needed for a correct and efficient use of the device.
- The given instructions of the operating manual, refers to the point in time of the device being placed on the market. The manufacturer reserves the right to introduce any modifications which prove necessary to the device and associated operating manual, without being bound to change previous devices and associated operating manuals.
- Use of the rehabilitation aid and its accessories, must be administered under medical supervision.
- The standing frame Vision® 2000 must only be operated under supervision of a qualified person, or respectively a family member of the user.
- Never leave the user of the aid unattended.
- The Vision® 2000 may only be operated by persons who have familiarized themselves with the standards and rules of the present operating manual.
- The Vision® 2000 may only be used by persons of a suitable stature and physical aptitude.
- Never place a patient in an aid, which is not coordinated with his or hers body height and weight.
- Adjust settings only in the unloaded condition.
- When using a standing aid, the overall centre of gravity is always relatively high up. A person who uses a standing aid is dependent on the stability of the device and support and guidance of the body as well as the footprint of the device.
- The VISION® 2000 is only intended for use in dry areas.
- The VISION® 2000 is not to be placed in front of open fireplaces.
- Do not place any hot beverages or objects onto the aid you have purchased, as this would seriously damage the aid.
- Do not load any heavy objects onto the aid, as this would impair the structure, the centre of gravity and consequently impair the balance.

- Always ensure there are no obstacles in operating range of the rehab aid, such as carpets, stairs or objects on the floor, which could lead to the standing frame Vision® 2000 overturning.
- Move all objects out of the way, which could be hit or fall whilst operating the aid.
- Never use the aid on rough terrain, steeply sloping ground or stairs.
- Do not move the aid, if a person is standing in the aid.
- Do not use the rehab aid before ensuring a complete and correct fitting of the safety belts, if available.
- Check all adjustable parts are locked, before every use of the aid.
- The brakes must be applied when the device is switched off or not in use.
- The attendant or carer must ensure that no part of the body can be squeezed or crushed when lifting or lowering the user.
- Apply the lever brakes for a secure stand when stopping.
- Always lock brakes before use, when setting, adjusting functions or accessories.
- Please note the individual and overall safety relevant information when using several rehabilitation aids simultaneously.
- All aspects of spatial influences (uneven, wet and smooth floors, steps or similar) must be taken into consideration by the carer or user.
- Do not use the Vision® 2000 before checking the wheels of the aid.
- Wet and dirtied wheels can decrease the braking effect.
- Check regularly if all screws and handles etc. are firmly tightened. Worn and defect parts are to be repaired or replaced immediately. This is especially important to ensure a safe use of the rehab aid! Carefully check the clamping jigs and the like are securely fixed.
- Do not use the aid, if parts of it are damaged or missing. Missing parts are only to be replaced with original spare parts.
- Do not carry out any interferences or measurements if you are unsure of their effects. For your own safety contact the nearest service centre or contact the dealer directly.
- In case of accidents or malfunctions, contact the dealer or manufacturer from whom you purchased the device.
- The manufacturer is not liable for damage to persons, objects or animals resulting from false usage of the equipment by the user or third parties, through incorrect mounting of parts and accessories, by neglect or poor maintenance, neglect, through unauthorized alterations and modifications, usage of non-original spare parts or accessories, through unpredictable and exceptional events resulting from non-compliance of the regulations in the presented operating manual.
- Clean the standing frame Vision® 2000 in accordance with the instructions given in the chapter „cleaning“.

Safety instructions

- Please ensure before use the product is cleaned according to the cleaning instructions and if indicated also disinfected.
- Any serious incidents occurring in connection with the product must be reported to the manufacturer (ATO FORM GmbH) and the competent authority of the country in which the user is resident.

**We constantly develop new aids and improve existing products. We are happy to receive your suggestions of every description.**



## 4 Warranty and product liability

ATO FORM grants the required by law warranty of your country against defects in workmanship and materials.

The warranty would be adversely affected if the customer's responsibility of servicing and/or daily maintenance is not carried out according to the guidelines and intervals prescribed by the supplier and/ or stated in the manual.

For further information, we refer to the ATO FORM homepage/download [www.ato-form.com](http://www.ato-form.com).

The warranty can only be sustained if the ATO FORM product is in use in the same country where it was purchased and if the product can be identified by the serial number. The warranty does not cover accidental damage, including damage caused by misuse or neglect.

The manufacturer's obligations transfer then to the person carrying out the modifications.

The warranty does not extend to non-durable parts, which are subject to normal wear and tear and need periodic replacement.

The warranty is null and void if non-original ATO FORM parts/accessories are used, or if the product is repaired or altered by anyone other than an authorized ATO FORM representative or by trained personnel officially recognized by ATO FORM for repair and maintenance of ATO FORM products.

ATO FORM reserves the right to inspect the product being claimed for and the relevant documentation before agreeing to the warranty claim and to decide upon whether to replace or repair the defective product. It is the customer's responsibility to return the item being claimed for under warranty to the address of purchase.

The warranty is given by ATO FORM or, subsequently, an ATO FORM dealer.

## 5 CE sign and position

The CE label with details of the manufacturer, article number, serial number and production date is located on the inside of the left vertical guiding post for table adjustment.



## 6 Indications and prophylaxis

The standing frame VISION® 2000 is a raising aid for adults.

The aid was developed to allow prolonged standing where the ability to stand is restricted or lost altogether. Such standing is indicated for, among other things, preparation for walking training and the recovery of the ability to walk, balance training, thrombosis prophylaxis, decubitus prophylaxis and metabolic stimulation. The standing aid can be used for spasticity inhibition and contracture prophylaxis in cases of paralysis of the legs; the legs and trunk; the legs, trunk and arms e.g. due to paraplegia, cerebral palsy, poliomyelitis or multiple sclerosis.

### **Contra indications**

Epilepsy, spasticity, contractures and damages to the upper and lower extremities, open wounds in the belt area.

 The list of contraindications does not grant guarantee completeness. The patient's general condition is an important part of the risk assessment. In individual cases, the decision must be made by the attending physician, who must weigh the risks versus the expected benefits.

## 7 Purpose of use

The VISION® 2000 was designed and built for:

- Exercise purposes for maintaining or independently upholding an upright standing body position;
- Maintenance of upright posture by means of a support belt running under the coccyx, or optionally available accessories, as an alternative to autonomous upright posture.
- Posture is the relationship between the body and the environment, which corresponds to the maintenance of a balance between the elastic forces of the extensor and flexor muscles as well as the internal body forces and the forces of the environment.

The VISION® 2000 is the aid by which this posture or this interaction of forces is made possible and facilitated.

The device must be prescribed by a medical specialist, who has tested beforehand and determined if the Vision® 2000 is suitable for the individual therapeutic goal of the patient. Furthermore, the medical specialist has determined the aid to be suitable according to measurements, weight and willingness of the patient to use the aid.

The aid is delivered via an authorised technician in compliance with the requirements of the country where it is being used and in strict accordance with the information and instructions in this manual for adjustments of the aid according to the measurements of the user. Only compliance of the regulations and instructions can lead to positive ergonomically effects.

We wish you every success when using the standing frame Vision® 2000.

## 8 Product overview

### 8.1 Basic model

- |   |   |
|---|---|
| 1 Handrail                                      | 4 Therapy table                         |
| 2 Knee supports; multi-dimensionally adjustable | 5 Rollen, feststellbar                  |
| 3 Heel support                                  | 6 Sicherungsgurt                        |
|   | 7 Tilt adjustment for the therapy table |



## 8.2 Accessories / options

If required, the Vision® 2000 standing bar can be quickly and easily converted with our retrofit kit for electronically assisted standing up.

Ask your specialist dealer or one of our rehab consultants for more information.

For a complete overview of our extensive range of accessories for the Vision® 2000 see item 11.2 Types and accessories on page 23/24.

## 9 Initial operation

The reseller is to unpack the unit, ensure that the components and accessories listed in the scope of delivery are all present and undamaged, and give the buyer the initial instructions on use of the aid. Above all the reseller should read through the complete present user manual carefully, in order to then explain it to the customer in detail.

This way, with help of the reseller, the user as well as the attendant must become familiar with the correct operation of the aid.

Once the demonstration has been completed, the reseller must ensure the user and/or

the assistant have fully understood the basic functions of the equipment. This is the only way to prevent the user from dangerous situations.

The above mentioned requirements must be observed for first use and also for reuse.

The seller must give instruction for use, as well as explain the basic functions of the device according to MPG (medical products law) to qualified staff.

## 10 Assembly and adjustment

### 10.1 Basic model

#### **Preparation:**

Unpack the product and remove the packing materials.

The device is completely assembled.

Ensure that the product is complete and undamaged.

#### **Use**

- The settings must be made according to doctor's instructions and according to indication.

#### **First adjustment of device settings without the patient**

To be regulated:

- Height of the tabletop as well as the handrails
- Knee pads, in height as well as in depth, width and inclination (multi-dimensionally adjustable). Reference point: knee.

#### **Following adjustment with the patient**

To be regulated:

- Depth and angle of the therapy table
- Position of the knee pads
- Position of the heel supports (depth)
- Adjustment of the posterior support unit (multi-dimensionally adjustable) (accessory)

! When positioning the limbs or the patient as shown in the instructions for use, we point out that we can only provide instructions for device settings.

Concrete statements and instructions for positioning cannot be derived from this. This is done by the responsible therapist or their specialist dealer who, together with the user, adjusts the device to suit individual needs. For this purpose, the described manual adjustment options of the device elements are used as well as the electrical functions, which are done in part by means of remote control or wireless control units.

### ***Discus elements***

To achieve the greatest possible variability, discus elements have been used on the Vision® 2000 standing frame. They can be used to adjust the distance, depth, inclination and rotation.

**IMPORTANT:** When attaching the discus elements vertically, the Allen screw head must always point to the left when viewed from the front. When attaching them horizontally (knee supports), the Allen screw head must always point upwards.

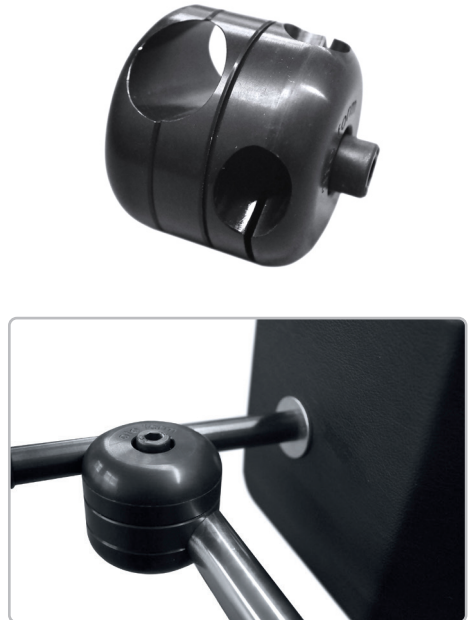
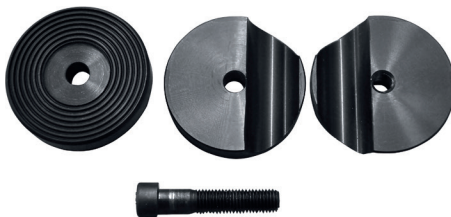

### ***Locking screws***

Locking screws have been used on the Vision® standing frame to enable tool-free adjustments. They can be used to adjust and secure the position.

**IMPORTANT:** When loosening the locking screws, first turn them approx. one turn and pull them out to adjust the element. Make sure that the locking screw engages correctly and tighten it again.

### **Adjustment of the height of the handrails**

The height of the table surface and the handrails can be adjusted separately.

- To adjust the handrails loosen the locking screws (1) on both sides of the VISION® 2000 (see illustration) with one turn and pull the locking screws outwards.
- Adjust the required height with the locking screws pulled out.
- Make sure that the locking screws click back into place in the holes (3) and turn them firmly.

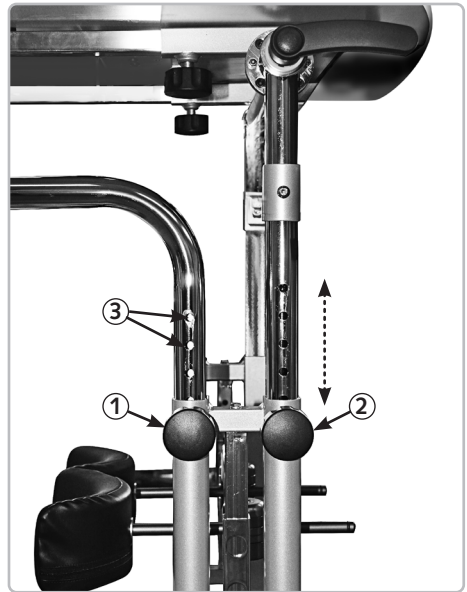

### **Setting the height of electronic device and therapy table**

The height adjustment of the therapy table is supported by mounted gas springs.

- Loosen the locking screws as described above (2) on both sides of the VISION® 2000 (see illustration) for the table.
- Set the required height.
- Make sure that the locking screws click back into place in the holes and turn them firmly.

#### **Caution!**

**In order to ensure sufficient comfort and support for the user, the work surface should, in most cases, be set so that it is below the user's elbows.**

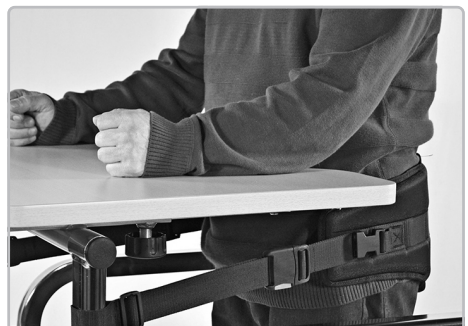



## Adjustment of knee supports

### Setting height

- The height adjustment is made via the central handle (1) (see illustration)
- Adjust the height of the knee supports with the cable pull lifted up to the handle.
- Release the cable pull and ensure that the bracket for the knee supports securely clicks into place in the side holes (2).
- Make sure the pads support the knees below the kneecap.

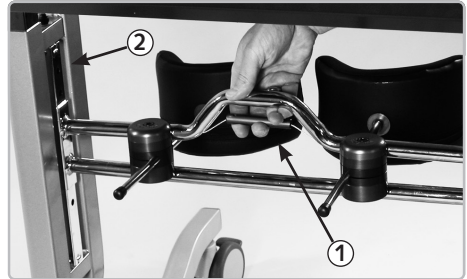

### Setting depth, distance, inclination and rotation

- Use the hexagonal wrench to loosen the screws in the disc elements connected to the knee supports. Hold the knee pad so that it does not tilt.
- Adjust the depth (A) and/or distance (B) of the respective knee support and retighten the screws in the disc elements.
- If necessary, the knee supports on the disc element can also be individually tilted (C) or rotated (D).
- When adjusting the knee supports and the heel rests, ensure that the patient's lower legs are largely vertical after they have been raised.

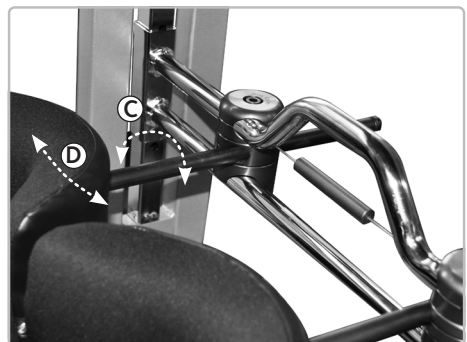
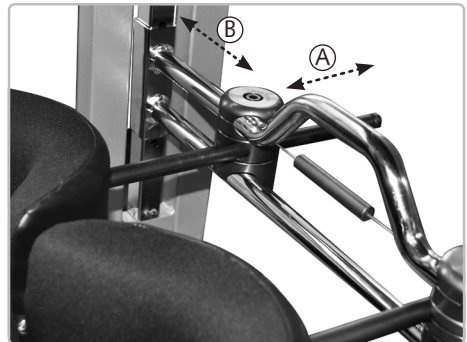

### ***Mounting the heel support***

In most cases, both heel supports should be placed at the same depth and distance to the centre.



### ***Positioning the wheelchair***

- Move the wheelchair close enough to the unit so that the front wheels touch the footrest of the VISION® 2000.
- Lock the wheels of the wheelchair.
- Always make sure that the wheels of the VISION® 2000 are securely locked in place with the brakes.

### ***Positioning the lower limbs***

- Position the patient's feet and secure them with the heel supports.
- When placing the feet, make sure that the back of the heels are properly placed in the heel supports and that the knee supports allow for a slightly bent posture of the knees. The lower legs of the patient should stand, as far as possible, vertically after the patient is raised.
- The free play of the knee supports can be increased or decreased depending on more or less upright posture (see „Adjustment of the knee supports“).



### ***Depth and inclination of the tabletop***

#### **Setting the depth**

- Release star knobs (1) below the tabletop.
- Set appropriate depth of the therapy table.
- Retighten star knobs.

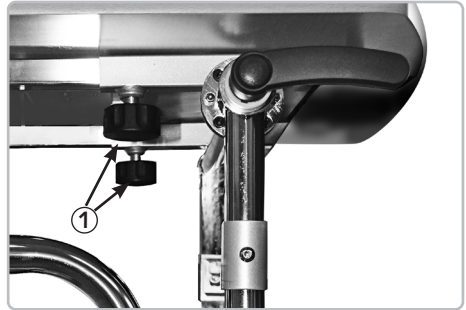

#### **Setting the inclination**

- Release the lever (2) on the right side below the table surface.
- Set the desired inclination of the therapy table.
- Secure the inclination of the therapy table by locking the lever.



### ***Safety belt***

The safety belt is pre-mounted on the standing frame underneath the therapy table. The length of the safety belt is adjusted on both sides by adjusting the webbing in the ladder buckles.

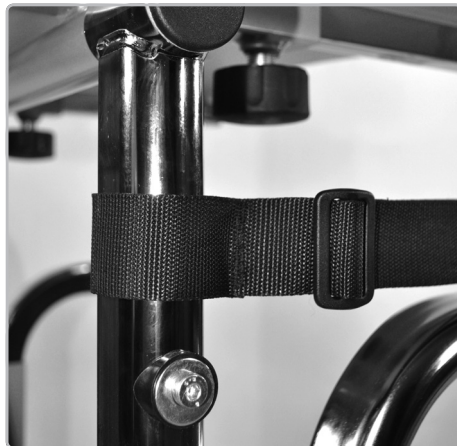

### ***Raising into the standing frame***

Patients with sufficient residual mobility and strength in their arms can raise themselves independently into the standing frame. For raising, the patient grasps the handrails and pulls himself up.

- If necessary, give the patient support when getting up.
- Secure the patient immediately with the safety belt as soon as he/she has reached the standing position.
- The belt fits correctly when it does not pass too loosely over the buttocks and the patient is held securely in the standing position.

For lowering (sitting down) the belt can easily be opened with one hand.



**!** Do not leave the patient unattended during the standing up process and give sufficient support if necessary.

## 10.2 Accessories / options

### **Mounting and adjusting the posterior supports**

The posterior supports (1) are mounted via the discus elements (2) on the articulated transverse guide, which is slid onto the support bar.

For this purpose, the screws of the discus elements (2) are removed, the two half-shells are each placed around the tube of the transverse guide and connected again by means of the cylinder screw.

The discus element is clamped at the desired position on the transverse guide by means of the cylinder screw.

By clamping the discus element on the transverse guide, the posterior support is simultaneously held in the desired position.

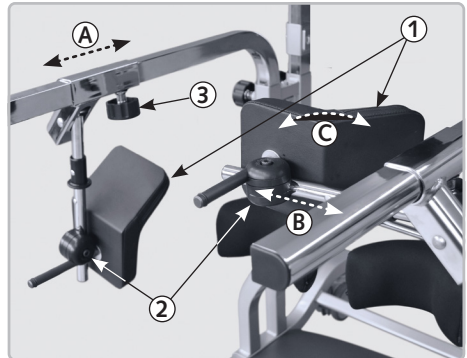

### **Setting on the handrail**

#### – Height

- The height of the supports is adjusted with the height adjustment of the handrails

#### – Depth (A)

- Loosen the locking screw (3) under the handrail with one turn and remove.
- Slide the posterior support along the frame to the position where the patient needs help.
- Make sure that the locking screws (3) click back into place in the holes and turn them firmly.

### **Settings on the discus element**

#### – Depth

- If necessary, the depth can be readjusted on the discus element

#### – Width (B) and angle (C)

- Loosen screw on discus element (2)
- Set necessary distance and angle of the supports on both sides
- Retighten the screws to secure the position of the supports

### Swivelling the posterior supports

- For patient access, push the plastic handles (D) towards the support and swing the support down.

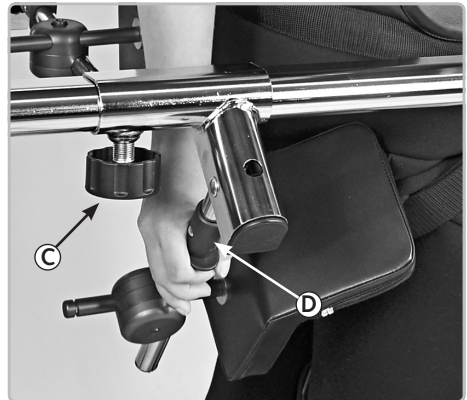

### **Belt systems**

The different belt systems are used as described in Section 10.1 („Mounting and adjusting“) on page 18/19.

### **Foot fixation, velcro**

Velcro fastening including screw connection

### **Forefoot fixation**

Including retention stop and foot loops

In many cases, it is necessary that the foot securing system or sockets are placed at the same depth and distance from the centre.

For a complete overview of our extensive range of accessories for the Vision® 2000 see item 11.2 Types and accessories on page 23/24.

## 11 Types and accessories

### 11.1 Basic model VISION® Junior

VSJ-2000 **Standing frame VISION® Junior**, inkl. pressure relieving stand up belt

### 11.2 Accessories / options Vision® Junior

For the standing frame VISION® Junior are currently following accessories available:

VSJ-0023 **Conversion kit for electrical supported standing up**

VSJ-0050 **Posterior support unit** left/right

VSJ-0060 **Back support with side support and headrest**

VS-0070 **Forefoot fixations**

incl. throw-over stop and foot loops (pair)

VSJ-0080 **Cushion for abdomen cut-out „soft“**

VS-0090 **Foot fixations, Velcro** incl. screw fitting



## 11.2 Accessories / options Vision®

VS-2000      **Standing frame VISION®**, inkl. pressure relieving stand up belt

## 11.2 Accessories / options Vision®

For the standing frame VISION® are currently following accessories available:

- VS-0023      **Conversion kit for electrical supported standing up**
- VS-0050      **Posterior support unit left/right**
- VS-0060      **Back support with side support and headrest**
- VS-0070      **Forefoot fixations**  
incl. throw-over stop and foot loops (pair)
- VS-0080      **Cushion for abdomen cut-out „soft“**
- VS-0085      **Cushion for abdomen cut-out standard**
- VS-0090      **Foot fixations, Velcro** incl. screw fitting

 **The most up-to-date overview of our extensive range of accessories for Vision® 2000 and their description as well as much more useful information can be found on our homepage [www.ato-form.com](http://www.ato-form.com).**

For special problems, or if it seems the accessories you require are not demonstrated nor described, please contact us.

We may already have the right solution for you.

## 12 Technical details

| Standing frame  |    | Vision® 2000     | Vision® 2000 Junior |
|---|----|------------------|---------------------|
| Item No   |    | VSJ-2000         | VS-2000             |
| Footplate ↔ therapy table   | cm | 87-100           | 93-120              |
| Footplate ↔ knee support  | cm | 30-50            | 38-56               |
| Height of the handrails (from footplate)                                      | cm | 69-90            | 80-104              |
| Floor ↔ upper edge footplate  | cm | 8                | 8                   |
| Chassis length  | cm | 100              | 103                 |
| Overall length (including wheels)   | cm |                  | 110                 |
| Overall frame width (including wheels)  | cm | 68               | 78                  |
| Therapy table (breadth x depth)   | cm | 65x60            | 75x60               |
| Maximum capacity for the therapy table  | kg | 50               | 50                  |
| Product weight  | kg | 49               | 49                  |
| Maximum load  | kg | 150              | 150                 |
| <b>Standing frame with electrically assisted standing up (Conversion kit)</b> |    |                  |                     |
| Power supply  |    | 230 V            |                     |
| IP Protection   |    | 21               |                     |
| Duty cycles   |    | 20% 4min/18 min  |                     |
| Fuse control board  |    | T 3, 15 A/250 VG |                     |

**Technical changes reserved!**

### **Construction**

The freestanding VISION® 2000 consists of: a powder-coated tubular steel frame, chrome-plated adjustable metal components, easy-to-clean foam padded supporting elements, therapy table and base of beechwood-look MDF, 4 polyamide double safety castors, each with full brake.

## 13 Cleaning and disinfection

Leftovers, dirt and dust are always to be removed. Moving parts work easier, if you apply one drop of oil after cleaning.

### **Cleaning the metal parts:**

The painted and chromed parts of the standing frame should only be cleaned using a soft cloth and mild and alcohol based customary cleaning agents.

### **Cleaning the imitation and wooden surfaces:**

The wooden surfaces should be cleaned using a damp cloth.

### **Cleaning the plastic parts:**

The plastic parts should only be cleaned using a soft cloth and mild and alcohol based customary cleaning agents.

### **Cleaning the rollers/wheels and joints:**

Keep these clean at all times; regularly remove dust, hairs and other accumulating dirt from rollers.

### **Cleaning of textiles and imitation leather:**

These are best cleaned using water and a mild detergent.

When using the cleaning agents the instructions of the manufacturer must be observed.

### **Disinfection:**

For disinfecting, use household disinfectants and consider the following indications:

The assistant must wear suitable protective clothing (for example gloves) in order to avoid infections.

When using disinfecting agents always follow the instructions of the manufacturer.

### **Warning**

**Do not use strong solvents, which could damage the surface of the device.**

**The use of a high-pressure cleaner will void the warranty.**

**Ensure that the upholstery and wooden surfaces are kept clean. Urine and sweat can damage the product.**

## 14 Maintenance and overhaul

For the protection of the warranty and safety, it is especially important that the standing frame is serviced regularly once a year from the date of purchase.

It is recommended to make service arrangements. The manufacture will gladly provide the maintenance check list to your specialist dealer on request.

Please contact your specialist dealer to carry out corrective maintenance works for your Vision® 2000.

The device should be checked by the manufacturer at the latest after 3 years.

### ***Maintenance Checklist***

#### **Castors**

- No damage or wear
- Firm seat

#### **Brakes**

- from grease and dirt
- Full brake function
- No signs of damage or wear

#### **Frame**

- Metal parts; no signs of damage or wear, especially for adjustable parts
- Welding seams are intact
- Fasteners, bolts, nuts and springs are secure
- Replacement of parts if there is any sign of wear
- No signs of wear or damage of the safety components

#### **Upolstered padding**

- No signs of wear

| Date | Service performed | Name | Sign |
|------|-------------------|------|------|
|      |                   |      |      |
|      |                   |      |      |
|      |                   |      |      |
|      |                   |      |      |
|      |                   |      |      |
|      |                   |      |      |
|      |                   |      |      |
|      |                   |      |      |
|      |                   |      |      |
|      |                   |      |      |
|      |                   |      |      |
|      |                   |      |      |
|      |                   |      |      |
|      |                   |      |      |
|      |                   |      |      |
|      |                   |      |      |

## 15 Operating life and Re-use

The Vision® 2000 is made from high quality materials and is subject to a continuous quality control in our house. Because of this and the solid construction, the expected operating life of our product is up to 5 years, depending on the usage intensity and number of re-uses, under normal and compliance with its intended use (according to the instructions given in our user manual).

The expected operating life does not apply to wear parts.

The product Vision® 2000 was designed so it could be reused after the application of various measures.

Following measures should be followed:

- Thorough cleaning and disinfecting using appropriate cleaning agents.
- Replacement of wear parts
- Maintenance, following the maintenance schedule of the manufacturer or authorized specialist dealer.
- Preparing accompanying documents and release for re-use.

## 16 Faults, repairs, spare parts

### **Your Vision® 2000 free-standing bar equipped with the retrofit kit for electronic assisted standing cannot be operated?**

Please ensure.....

- The plug is plugged in the socket and is supplied with power.
- The main switch is on, and the batteries are in the remote control.
- The emergency button located on the left side of the housing is completely pulled out.
- All plug connections are plugged in correctly and secured.

Try and shut down the fault.

Failing that, contact your specialist dealer / reseller.

Only original accessories and original spare parts may be used. Non-compliance with these instructions and repairs carried out or modifications made to the Vision® 2000 or its parts by unauthorized persons, voids any warranties.

In these cases, any product liability granted by the manufacturer (ATO FORM GmbH, Zur Lauterhecke 34, 63877 Sailauf, Germany) is voided in advance.

For all questions about spare parts and accessories contact your specialist dealer or the ATO FORM-Service +49 6093 944-0.

 **Spare parts and accessories must not be removed or replaced while the patient is using the standing frame!**

## 17 Storage

Keep this operating manual in a safe place, where you or care and maintenance staff have access to it.

The current version of these instructions for use can be found on our homepage in the download area.



You can find more information about the product on our homepage at [www.ato-form.com](http://www.ato-form.com) or under this QR code.









### Disposal of battery operated devices



The battery pack must not be disposed of together with normal household waste at the end of its service life. Please observe the legal requirements in your area. Your municipal government and locally based waste disposal companies will be happy to provide you with information in this regard.

### **In environmental protection matters:**

**All packaging parts are re-useable. The cardboard packaging is to be recycled as waste paper. We therefore use paper as filler material. Possible used plastic film of the packaging are made out of PE and are therefore low in pollutant and can either be recycled or burnt.**

Complete Range:

- Head and body protection
- Walking aids
- Gait trainer
- Standing aids
- Seating aids
- Hoists
- Customized solutions

Thank you for your interest in our products.  
For questions please contact ATO FORM GmbH  
or your specialist dealer.

Your ATO FORM Team



**ATO FORM GmbH**

Zur Lauterhecke 34, 63877 Sailauf, Germany

Tel. +49 6093 944-0, Fax +49 6093 944-444

E-Mail: [info@ato-form.com](mailto:info@ato-form.com)

[www.ato-form.com](http://www.ato-form.com)

Your specialist dealer